



This Tree Themed Shade offers a unique shape that will provide much needed shade to your environment. Inspired by nature, the canopy can be used in a variety of ways, such as over a bench or to shade your play space.



Hyper Tree Themed Shade
3000004

L: 14'-0" x W: 14'-0" x H: 11'-6"
450 LBS

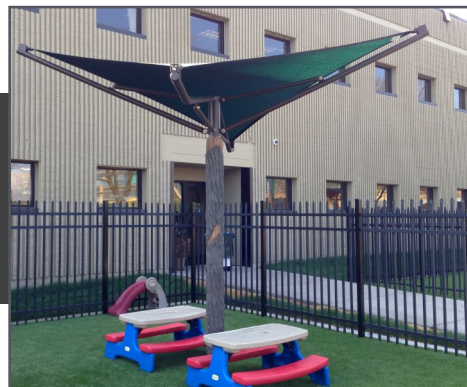

~ Dimensions and weights are approximate ~
~ Heights shown from top of surfacing ~

Installation Instructions

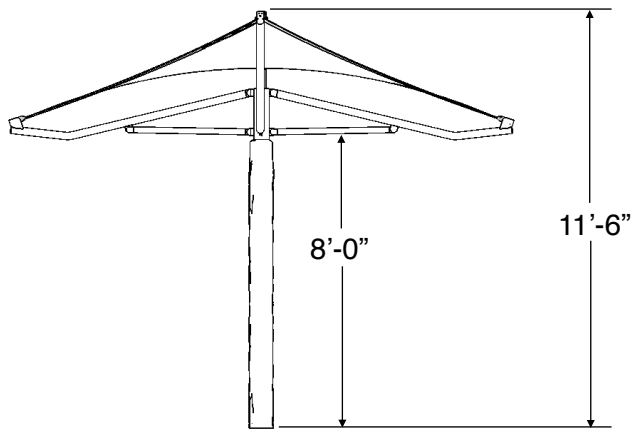
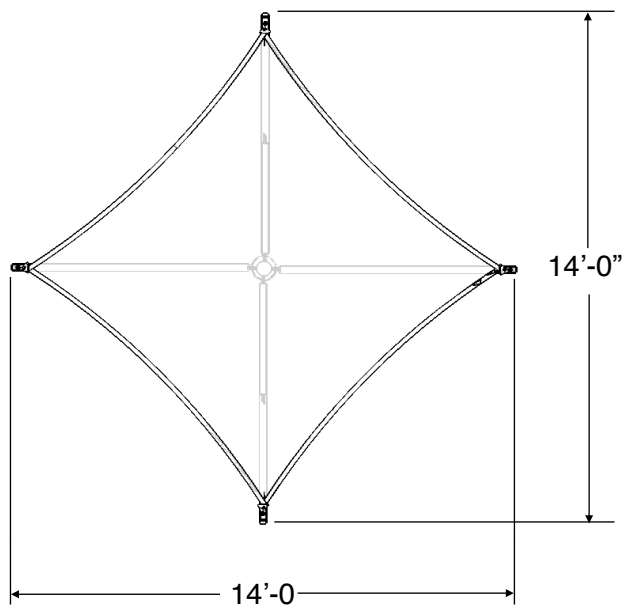

Included Items:

Item	Description	Quantity
Hypar Shade Structure Kit	Site Amenity	1
Themed Tree Sleeve	Theming	1
U-Bolt	Installation Aid	1

~ All dimensions are approximate ~

Last Revised 8/15/19

Installation Instructions

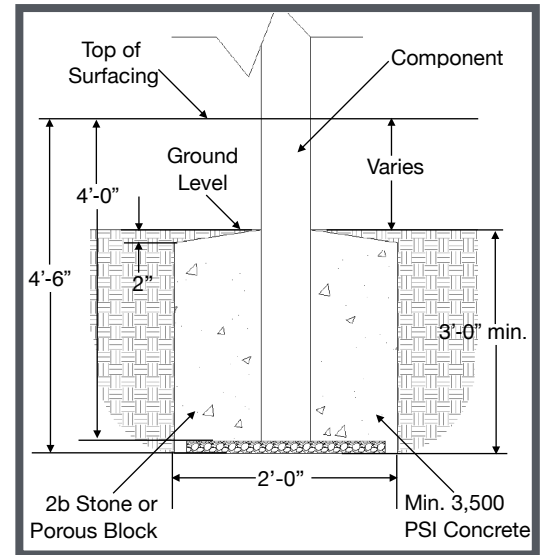
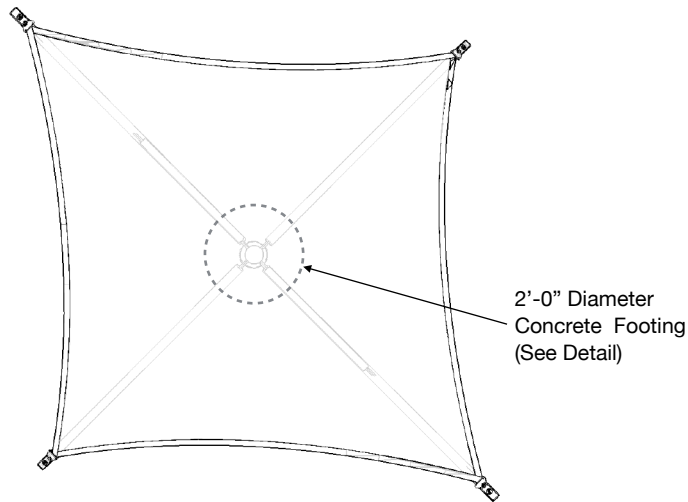

Typical Component Footing Detail

Check local soil conditions.
(Not to Scale)

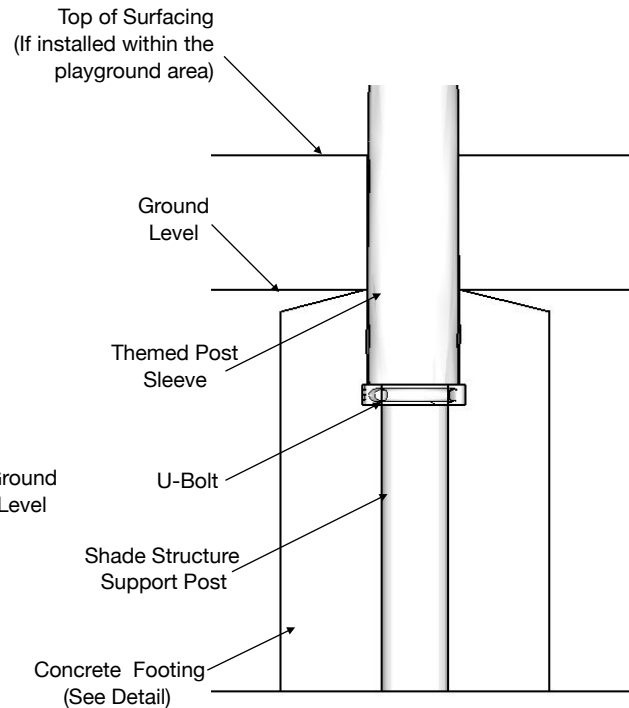
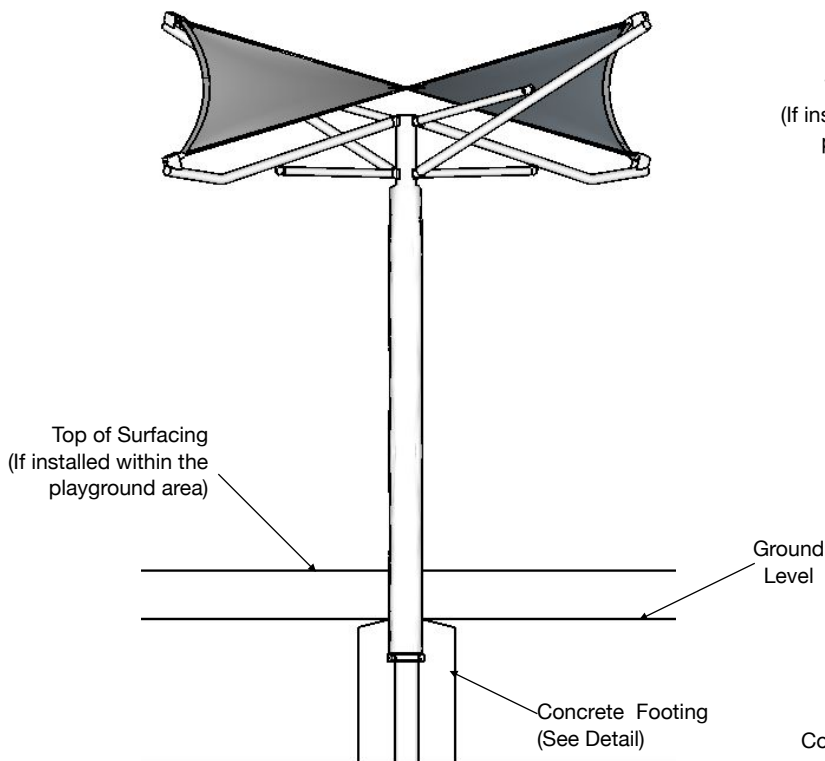

~ All dimensions are approximate ~

Installation Instructions

Notes Before You Begin: Do not over tighten bolts during assembly, only snug tighten them until assembly is complete.

Structure Instructions

Step 1: Before attempting to assemble your equipment, please review all installation information carefully. Should you experience any difficulty during the installation process, please call us at the phone number shown on the bottom of these instructions.

Step 2: Separate and identify all components and hardware.

Step 3: Place the shade structure support post in a horizontal position. Slide the themed post sleeve over the support post within 2-1/2" of the canopy tabs. Using clear silicone adhesive/caulk, put a 1/4" bead all the way around the support post against the themed post sleeve. Slide the themed post sleeve up 1" over the silicone so the themed post sleeve is 1-1/2" away from the support tabs. Install the U-bolt on the support post at the base of the themed sleeve (this will hold the themed sleeve in place while setting the post assembly). Once the post is set, seal the top of the themed sleeve to the support post with silicone caulk/adhesive.

Step 4: Lay out area and prepare site for install. Refer to the typical in-ground footing detail on excavating a hole for the the Tree Themed Shade. Concrete must be installed over a solid, level base. Check local soil condition and codes. Excavate the footing as shown on page 2 of this document. Place the support post into the footing, plumb and level. Block, brace, and pour concrete. The concrete should be flush with the ground level. Allow 72 hours for concrete to completely cure.

Fabric Instructions

Step 5: Attach the brace frames to the support post. See Detail A. Position (2) two brace frames against the top tabs on the support post and (2) two brace frames against the bottom tabs and attach as shown. Note: orient the braces on the support post as shown. The lower braces will be pointing in the opposite direction of the upper braces.

Step 6: Attach the lower rafters to the support post and lower brace frames. See Details B-1 and B-2. Attach the lower rafters to the support post and then the lower brace frames as shown.

Step 7: Attach the upper rafters to the support post and upper brace frames. See Details C-1 and C-2. Attach the upper rafters to the support posts and then the upper brace frames as shown.

Step 8: Attach the traveler blocks to the shade fabric. See Detail D. Insert the tri-ring on the end of each flap of the fabric into a traveler block, apply a drop of thread locking adhesive to the bolt threads, and attach as shown. Fully tighten the fasteners according to tightening torque specifications.

Torque Specifications:

Bolts and nuts - Snug tighten and then tighten an additional one-half turn.

~ All dimensions are approximate ~

Installation Instructions

Step 9: Attach the threaded rods to the traveler blocks and tighten the shade fabric on the upper and lower rafters. See Details E-1, E-2 and E-3. Slide each threaded rod through a bearing and a washer then thread about 2" onto a coupling nut. Insert the long exposed end of each threaded rod through a bracket on the end of a rafter and thread part way into the traveler block. With a pair of pliers holding the threaded rod in place, rotate the coupling nut to draw the traveler block to the bracket on the rafter. Evenly tighten each block a little at a time.

Step 10: Attach the traveler blocks to the upper and lower rafters. See Detail F. When the block is tightened close enough to the rafter bracket apply a drop of thread locking adhesive to the bolt threads and attach as shown. Finish tightening the fabric before making the final connection in the next step.

Step 11: Finish attaching the traveler blocks to the upper and lower rafters. See Detail G. Remove the threaded rod, washer, bearing, and coupling nut from the traveler block. Retain the washer for the final connection of the traveler block to the rafters. Apply a drop of thread locking adhesive to the bolt threads and attach the block to the rafter bracket as shown.

Final Details.

Step 12: Plumb and level the component. Fully tighten all fasteners according to tightening torque specifications.

Torque Specifications:

Bolts and nuts - Snug tighten and then tighten an additional one half turn.

NOTES PRIOR TO CONSTRUCTION:

- Use appropriate equipment to lift and move the site amenity.
- Check local codes and requirements prior to digging or installing any equipment.

~ All dimensions are approximate ~

Installation Instructions

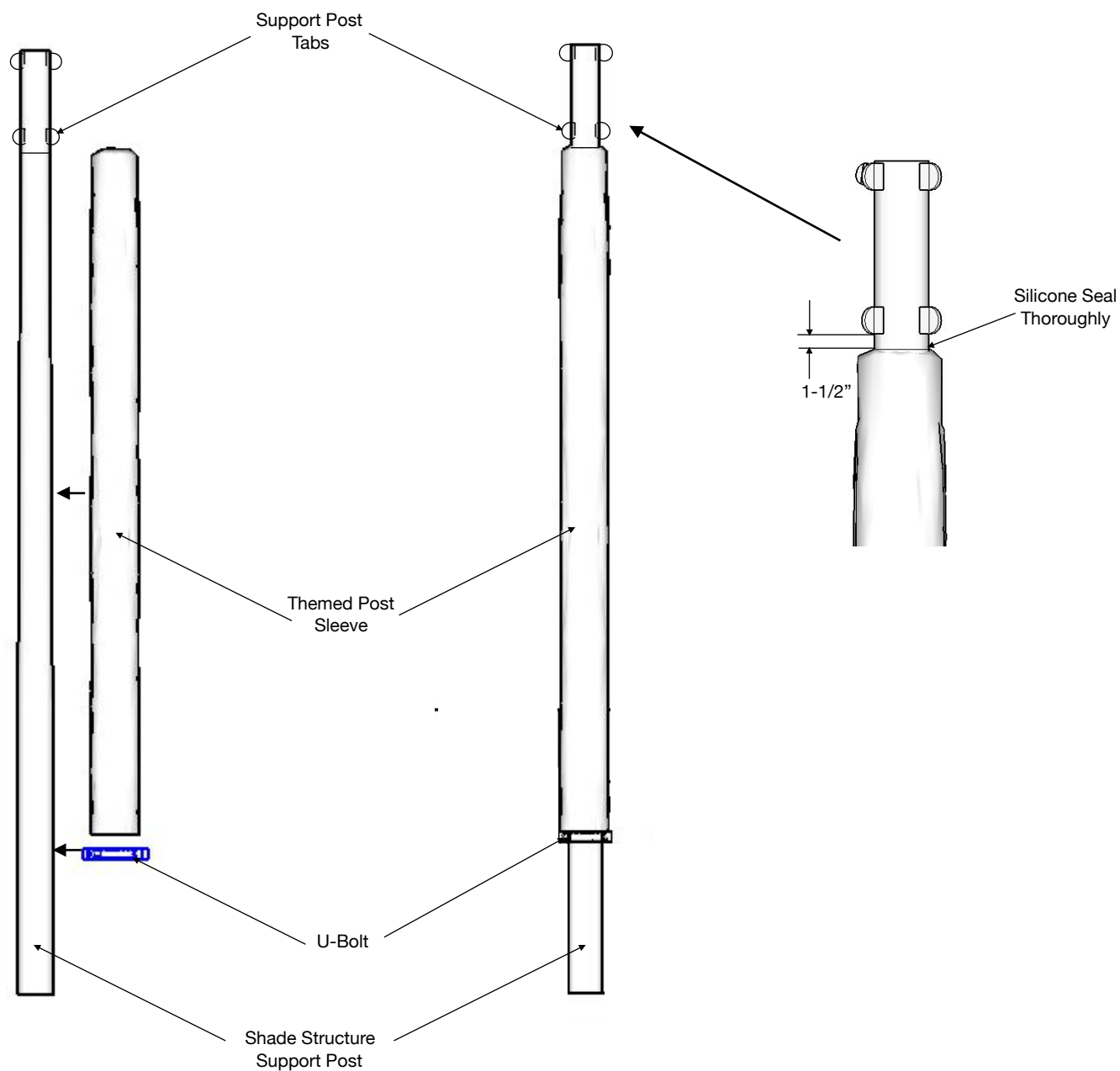

Step 3

~ All dimensions are approximate ~

Installation Instructions

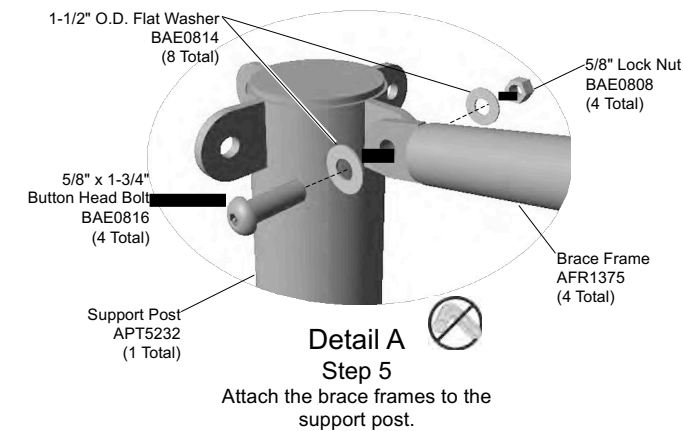

Note: Orient the braces on the support post as shown. The lower braces will be pointing in the opposite direction of the upper braces.

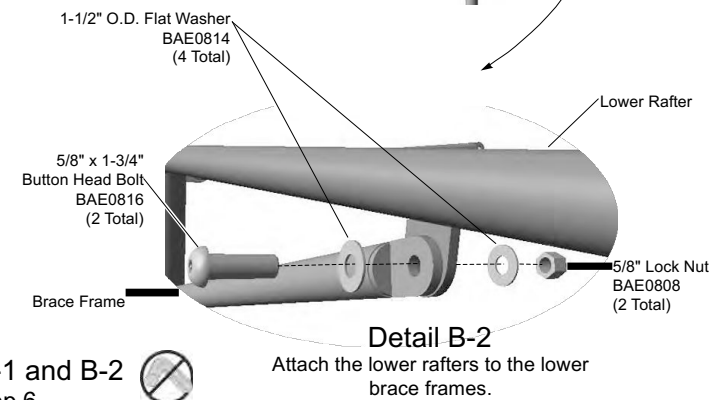
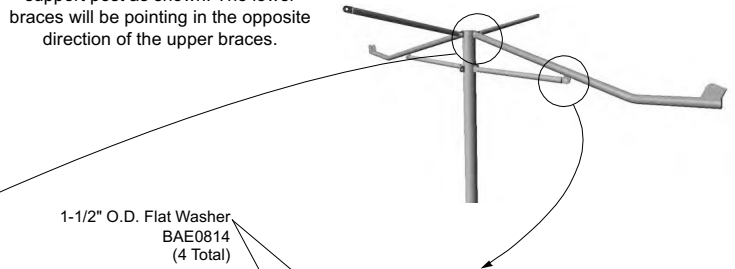
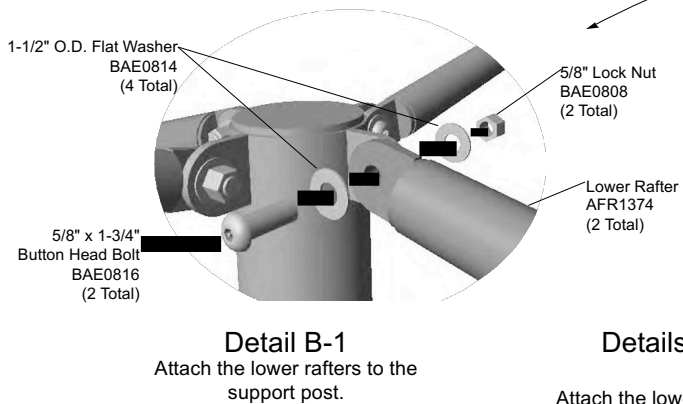

Details B-1 and B-2
Step 6
Attach the lower rafters to the support post and lower brace frames.

~ All dimensions are approximate ~

Installation Instructions

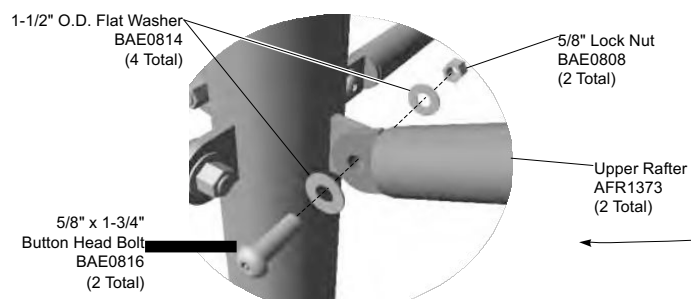

Detail C-1
Attach the upper rafters to the support post.

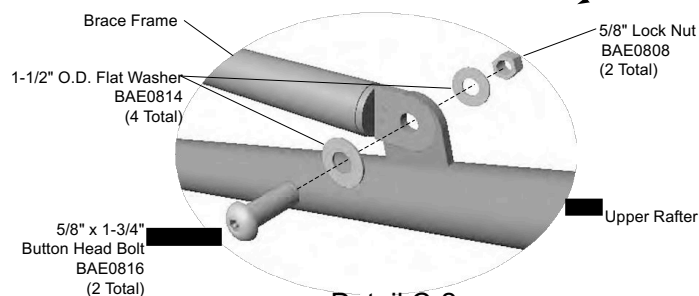

Detail C-2
Attach the upper rafters to the upper brace frames.

Details C-1 and C-2
Step 7
Attach the upper rafters to the support post and upper brace frames.

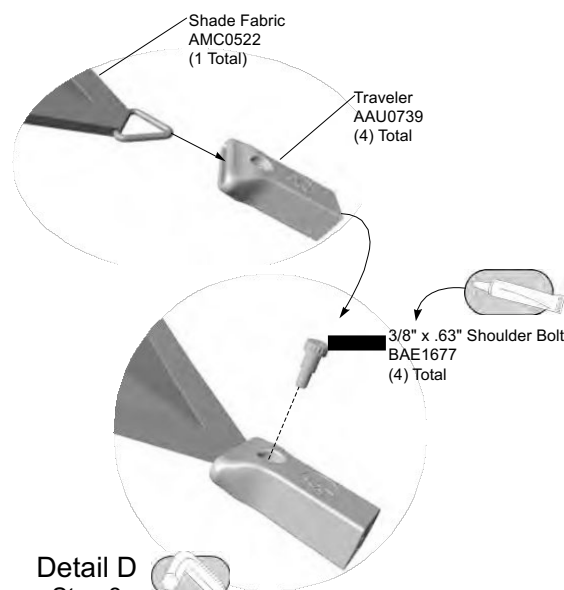
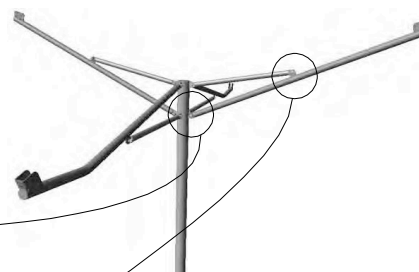

Detail D
Step 8
Attach the traveler blocks to the shade fabric.

~ All dimensions are approximate ~

Installation Instructions

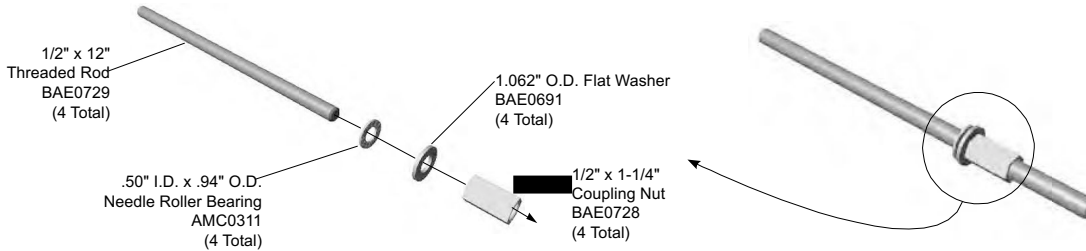

Detail E-1

Slide the threaded rod through the bearing and washer then thread about 2" onto the coupling nut.

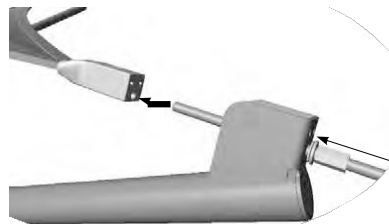

Detail E-2

Insert the long exposed end of the threaded rod through the bracket on the end of the rafter and thread part way into the traveler block.

*Note: Use a ratcheting wrench, and provided deep well socket, on the coupling nut to pull the traveler closer. Bring all travelers to 6" (150 mm) from end bracket. Then ratchet further to bring it into the bracket.



Detail E-3

With a pair of pliers holding the threaded rod in place, rotate the coupling nut to draw the traveler block to the bracket on the rafter (See *Note).

Details E-1, E-2 and E-3

Step 9

Attach the threaded rods to the traveler blocks and tighten the shade fabric on the upper and lower rafters.

~ All dimensions are approximate ~

Installation Instructions

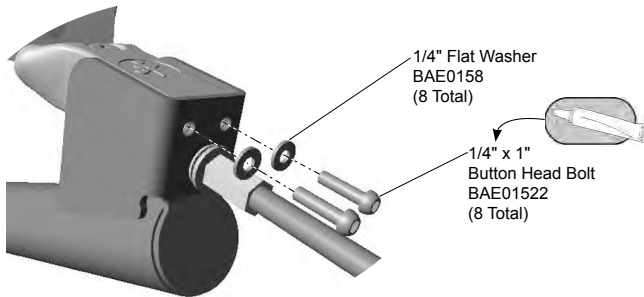

Detail F
Step 9

Attach the traveler blocks to the upper and lower rafters.

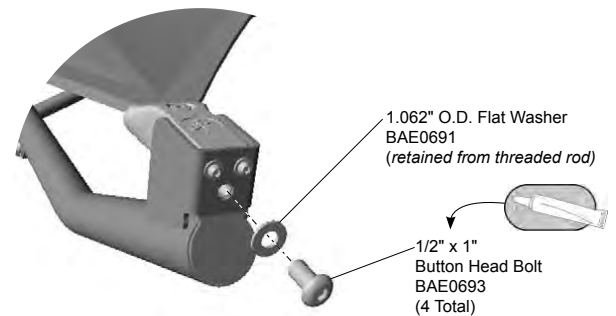
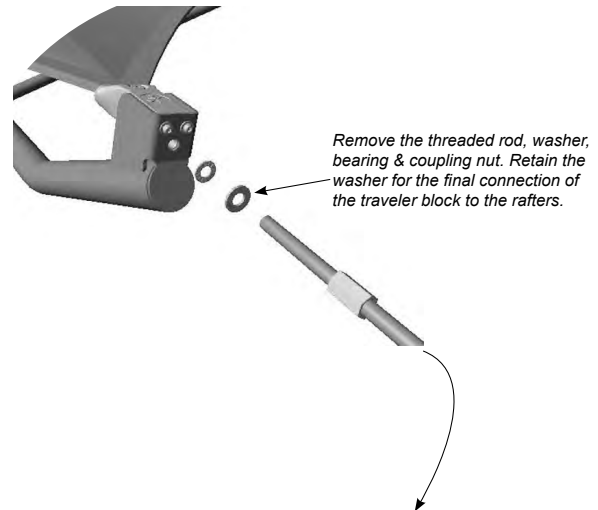

Detail G
Step 11

Finish attaching the traveler blocks to the upper and lower rafters.

~ All dimensions are approximate ~