



When is it fun to step on critters? At the park of course. Kids can step and play on these critters all day long. Made of durable long-lasting Glass Fiber Reinforced Concrete (GFRC), our steppers will stand the test of time!



Frog Stepper
1000221

L: 1'-11" x W: 1'-6" x H: 0'-10"
50 LBS



Turtle Shell Stepper
1000222

L: 1'-11" x W: 1'-6" x H: 0'-7"
30 LBS

Installation Instructions

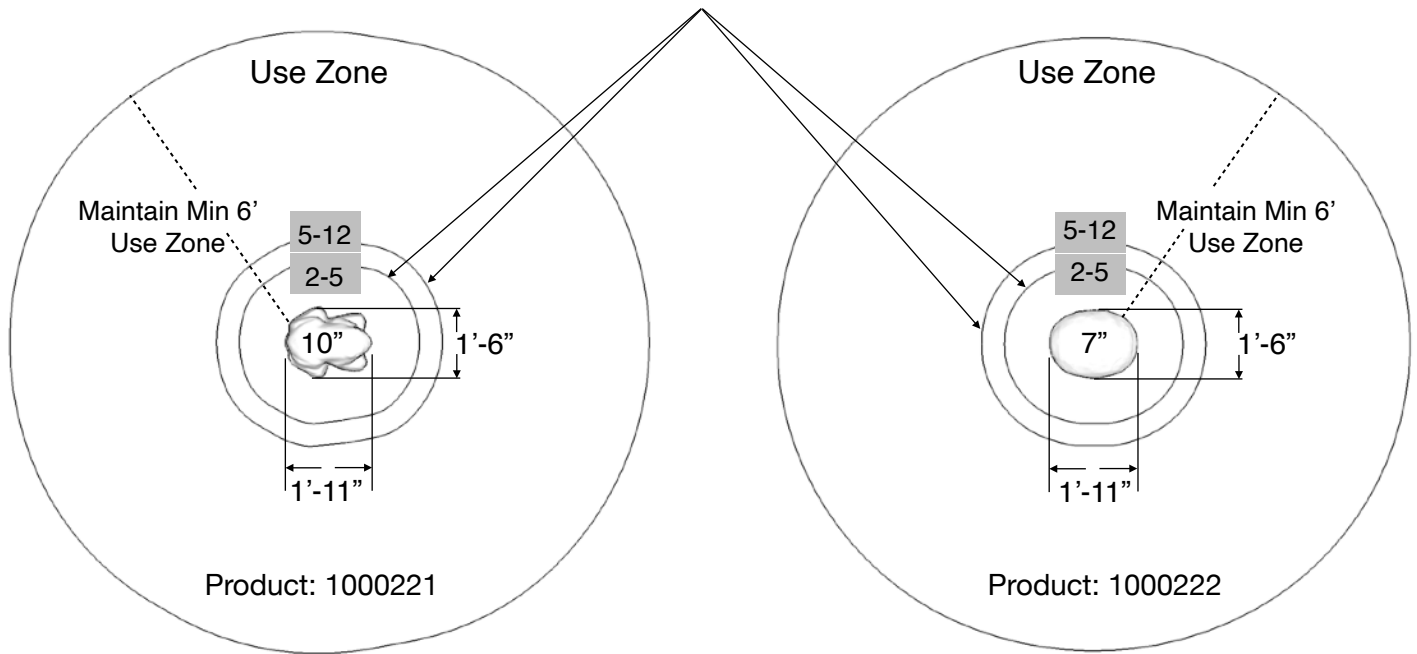

Stepping forms shall be no greater than 12 in. (300mm) apart when intended for use by 2 through 5-year-olds and no greater than 18 in. (460 mm) apart when intended for use by 5 through 12-year-olds. This dimension shall be measured edge to edge between the adjacent stepping surfaces. (This measurement will be horizontal when adjacent stepping forms are at the same height and it will be diagonal when adjacent stepping forms are at different heights.)

Included Items:

Item	Description	Quantity
Stepper	Play Equipment	1

Installation Instructions

Place on top of Surfacing

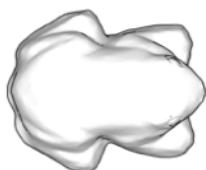

1000221

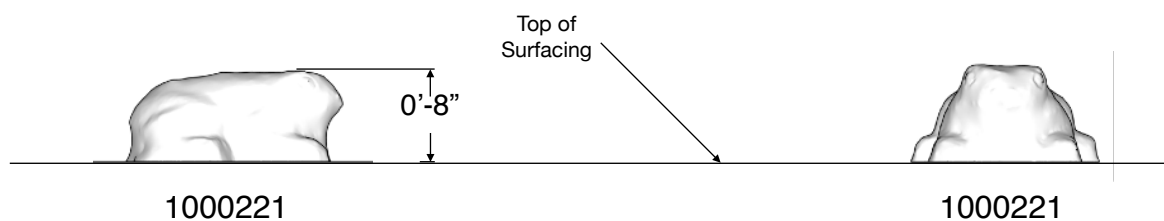

1000222

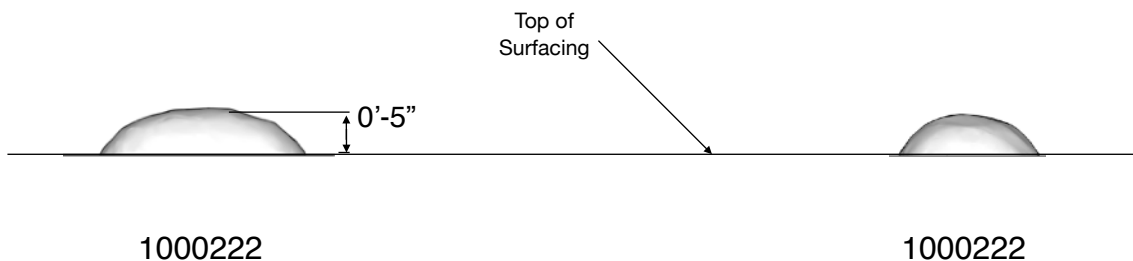

Installation Instructions

Optional - Below Surfacing

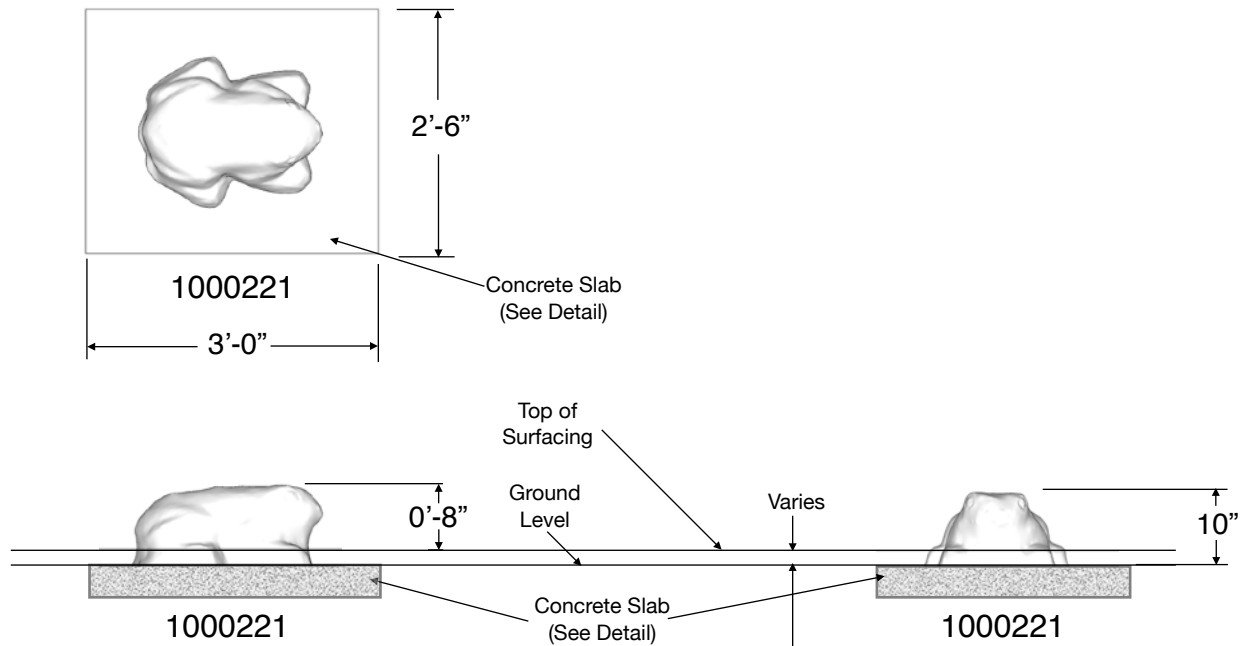

Optional

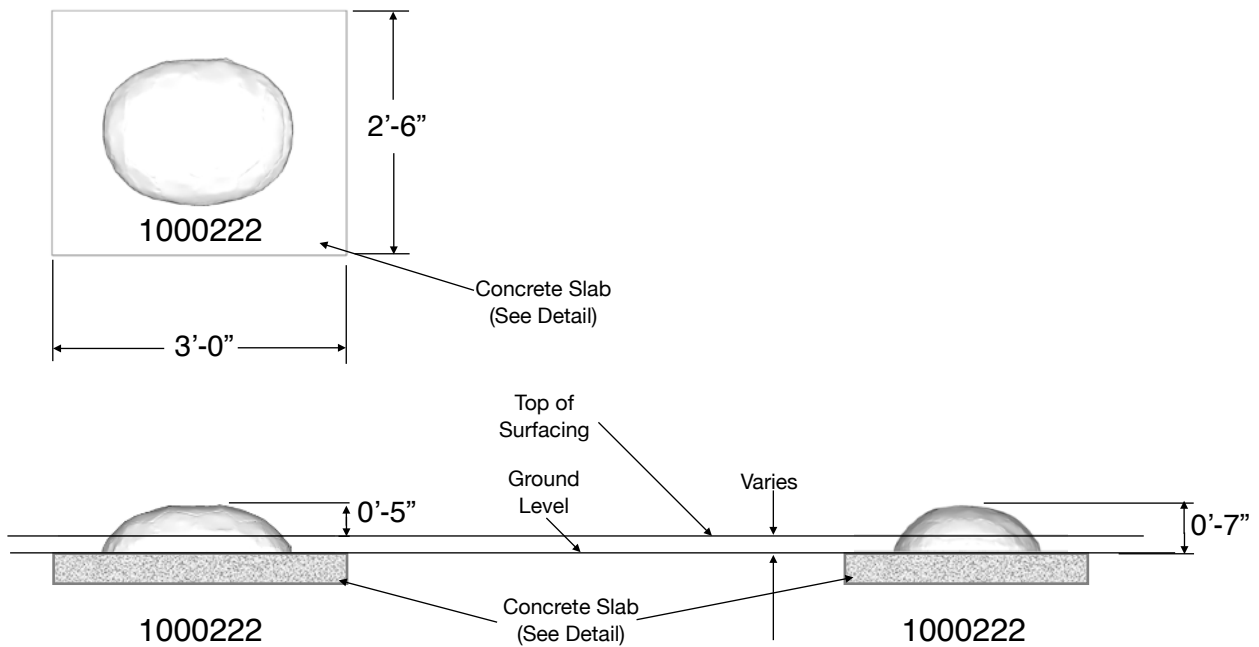

Optional

Installation Instructions

Optional - Below Surfacing

NOTE: Read installation instructions thoroughly before starting installation process.

Step 1: Lay out the area and prepare the site for install. Concrete must be installed over a solid, level base. Check local soil condition and codes. See product installation instructions for minimum use zone requirements to ensure proper spacing and adequate surfacing area.

Step 2: Pour a concrete base for the stepper. Refer to the typical slab section on this page. The concrete should be flush with the ground level. Allow time for the concrete to completely cure before continuing.

Step 3: Using the appropriate equipment, place the stepper into final installation location. Use a PLC type construction adhesive to anchor the equipment down to your slab. Refer to the surfacing manufacturer for installation of an approved impact attenuating play surface around the stepper with a minimum of 6 feet in every direction.

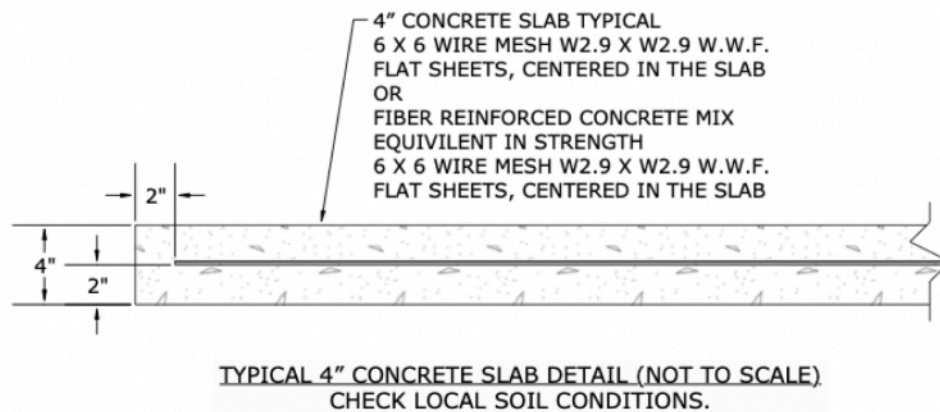

NOTES PRIOR TO CONSTRUCTION:

- Use appropriate equipment to lift and move the play equipment.
- Check local codes and requirements prior to digging or installing any equipment.

