

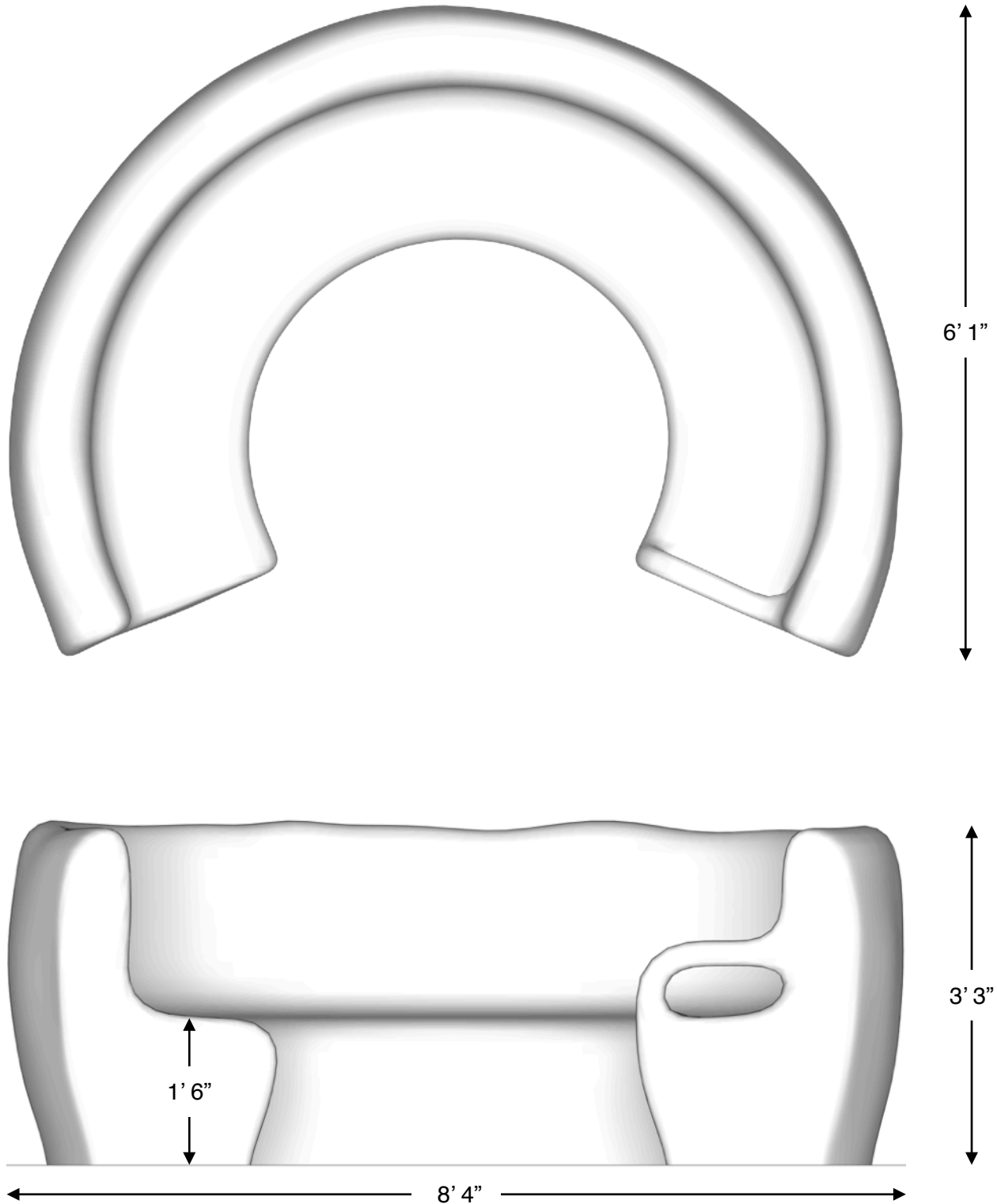

The Nest Bench is inspired by nature. This durable Glass Fiber Reinforced Concrete (GFRC) constructed bench impresses with its styling.



L: 8' 4"
W: 6' 1"
H: 3' 3"
3,200 LBS



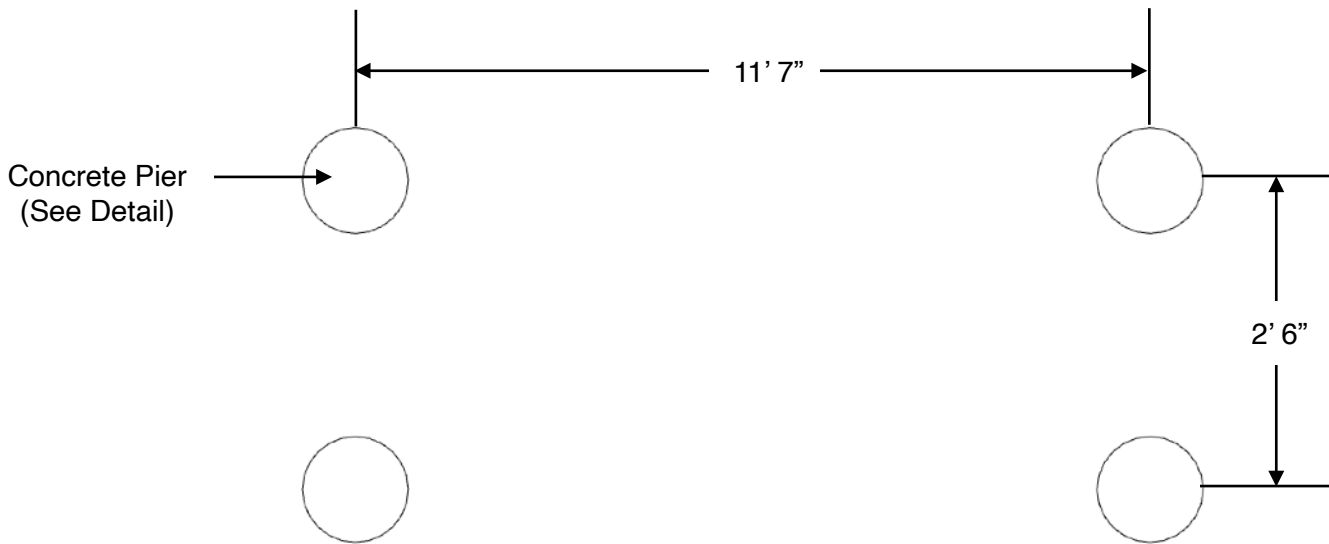
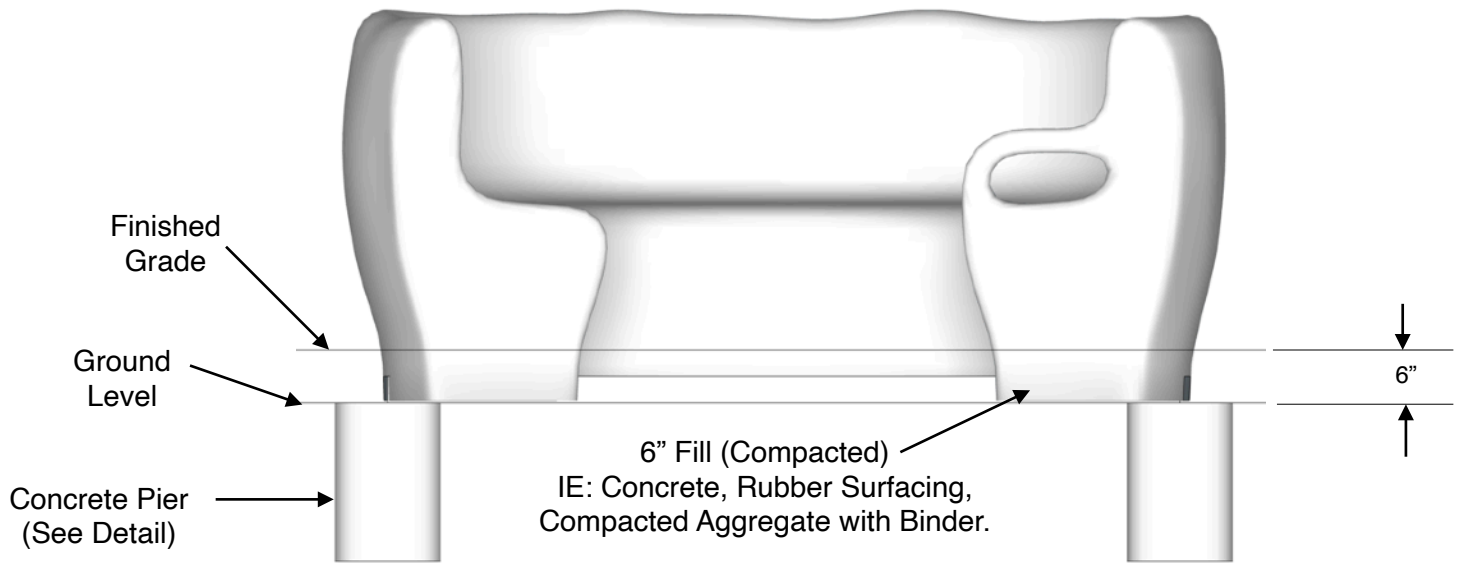

If you determine that less than 6" of fill is required, make sure the top of the concrete piers are 6" below the top of the finished grade.

NOTE: Read installation instructions thoroughly before starting installation process.

Step 1: Lay out the area and prepare the site for install. Concrete must be installed over a solid, level base. Check local soil condition and codes.

Step 2: Refer to the typical in-ground concrete pier detail on excavating a hole for the component.

Step 3: Pour a concrete pier. The concrete should be flush with the ground level, as shown in the typical in-ground pier detail. Allow time for the concrete to cure completely before continuing.

Step 4: Using an appropriate forklift or boom, place component into final installation location. See the hardware recommendation for information on anchoring equipment down to your concrete pier.

Step 5: Locate your anchor bolts, supplied. Using the proper standard drill bit size noted in the installation table, drill the concrete to the appropriate hole depth through the mounting holes.

Step 6: Insert the anchor bolt into the hole and tighten until the bolt is fully seated. Do NOT over tighten the anchor bolts.

Step 7: Install 6" fill around the bench to finished grade.

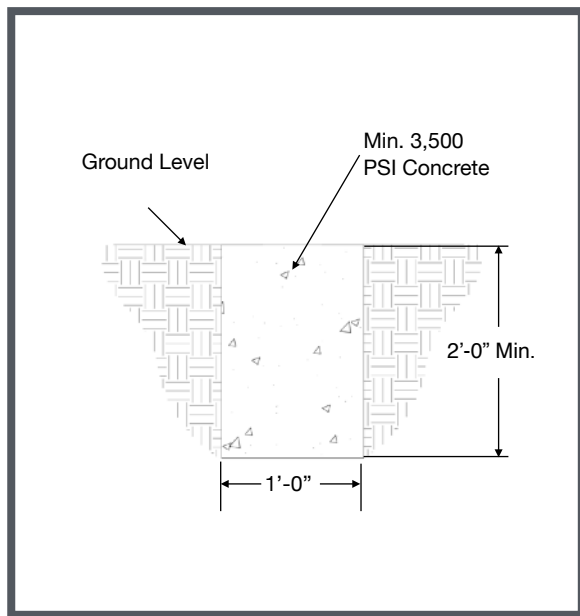

Typical Pier Detail
Check local soil conditions.
(Not to Scale)

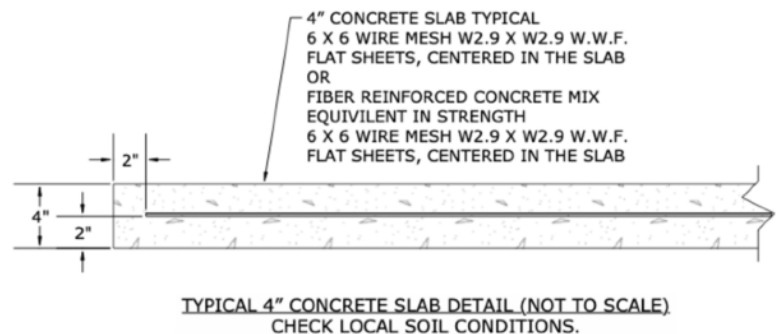

TYPICAL 4" CONCRETE SLAB DETAIL (NOT TO SCALE)
CHECK LOCAL SOIL CONDITIONS.

Included Items:

| Item | Description | Quantity |
|-----------------------|-------------------|----------|
| Nest Bench | Play Equipment | 1 |
| Anchor Bolt 1/2" x 3" | Mounting Hardware | 4 |

NOTES PRIOR TO CONSTRUCTION:

- Use appropriate equipment to lift and move the play equipment.
- Check local codes and requirements prior to digging or installing any equipment.

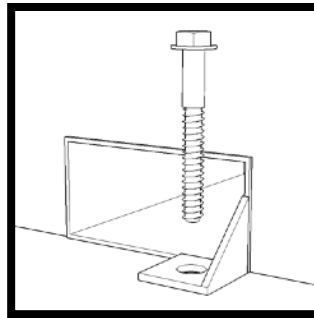
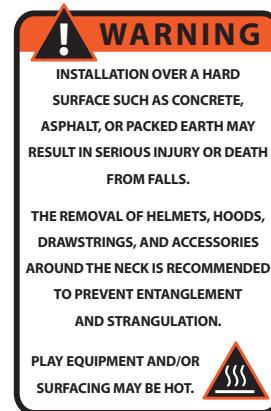

Mounting Detail
(Not to Scale)

Anchor Bolt Installation:

| Anchor Bolt Size | ANSI Standard Drill Bit Diameter | Anchor Head (Socket Size) | Minimum Embedment | Hole Depth |
|------------------|----------------------------------|---------------------------|-------------------|------------|
| 1/2" x 3" | 7/16" | 3/4" | 2 1/2" | 3 1/2" |
| 5/8" x 4" | 1/2" | 13/16" | 3 1/2" | 4 1/2" |
| 5/8" x 6" | 1/2" | 13/16" | 5 1/2" | 6 1/2" |

Step 1: Drill

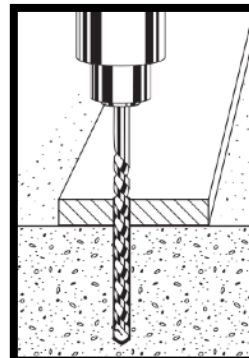

Step 2: Anchor

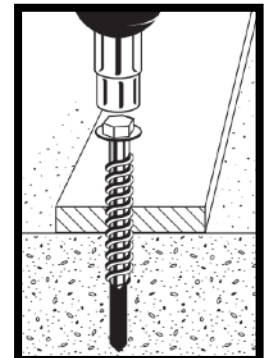

NOTE: Always wear eye protection appropriate to the task at hand.